

TOTAL MILES
 Borough Road System 28.46
 State Highway System 5.36
 Total 33.82

POPULATION 18,461
 (2010 Census)

2023 PECO Gas Work

LEGEND

- LIMITED ACCESS HIGHWAY
- STATE ROUTE AND NUMBER
- STATE MAINTAINED BRIDGE ON BOROUGH STREET
- BOROUGH STREET NAME AND SEGMENT LENGTH IN MILES
- TURNBACK BOROUGH STREET
- BOROUGH ALLEY
- OTHER ROAD
- RAILROAD
- STATE BOUNDARY
- COUNTY BOUNDARY
- TOWNSHIP BOUNDARY
- CITY BOUNDARY
- BOROUGH BOUNDARY
- MUNICIPAL BUILDING
- SPLIT MILEAGE BETWEEN MUNICIPALITIES
- SCHOOL, COLLEGE OR UNIVERSITY
- POINT OF INTEREST

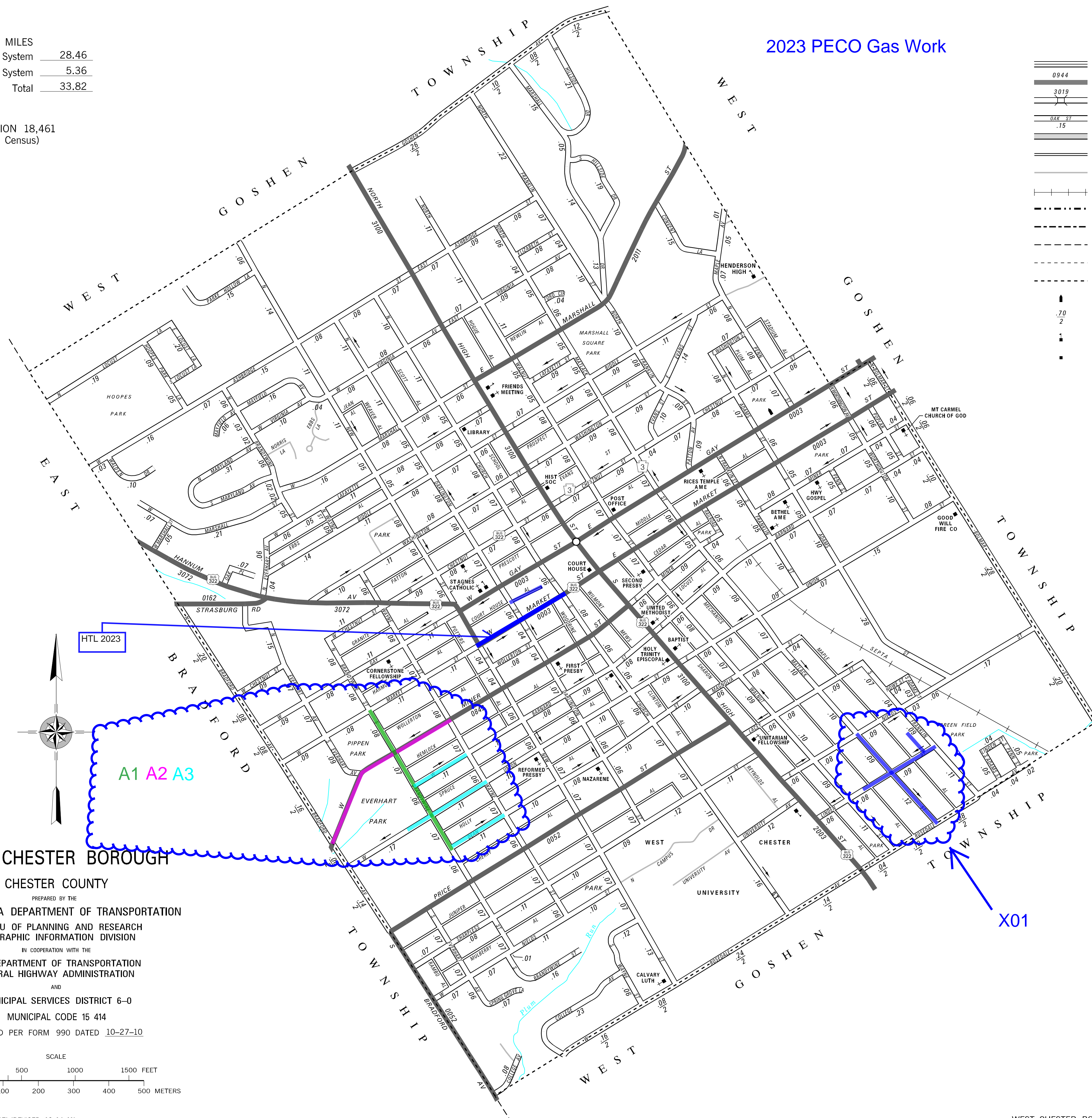

HTL 2023

A1 A2 A3

X01

WEST CHESTER BOROUGH

CHESTER COUNTY

PREPARED BY THE
 PENNSYLVANIA DEPARTMENT OF TRANSPORTATION
 BUREAU OF PLANNING AND RESEARCH
 GEOGRAPHIC INFORMATION DIVISION
 IN COOPERATION WITH THE
 U.S. DEPARTMENT OF TRANSPORTATION
 FEDERAL HIGHWAY ADMINISTRATION
 AND
 MUNICIPAL SERVICES DISTRICT 6-0
 MUNICIPAL CODE 15 414
 REVISED PER FORM 990 DATED 10-27-10

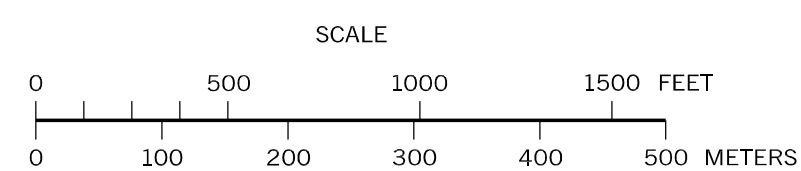

- ADAMS ST
- ASHBRIDGE ST
- BARNARD ST
- BIDDLE ST
- BOLMAR ST
- BRADFORD AV
- BRANDYWINE ST
- CHESTNUT ST
- CHURCH ST
- COLLEGE AV
- CONVENT LA
- DARLINGTON ST
- DEAN ST
- ELIZABETH ST
- EVANS ST
- EVERHART AV
- FORD CIR
- FRANKLIN ST
- GAY ST
- GOSHEN AV
- HILLSIDE DR
- HOOPES PARK LA
- HOWE ST
- LACEY ST
- LAFAYETTE ST
- LINDEN ST
- LOCUST LA
- MAGNOLIA ST
- MAPLE AV
- MARSHALL DR
- MARSHALL ST
- MARYLAND AV
- MATLACK ST
- MAYFIELD AV
- MINER ST
- NEW ST
- NIELDS ST
- OAK PL
- PARKE HOLLOW LA
- PATTON AV
- PENN ST
- POPLAR ST
- RAILROAD ST
- ROSDALE AV
- SHARPLESS ST
- SPRING GROVE LA
- UNION ST
- UNIVERSITY AV
- VIRGINIA AV
- WALDEN DR
- WALNUT ST
- WASHINGTON ST
- WAYNE ST
- WOLLERTON ST
- WORTHINGTON ST